

REELL WRAP SPRING SLIP CLUTCH

SHAFT NOM.	DIA. "A"	DESCRIPTION: SA-Nm-DIR-BORE 6mm BORE SHOWN
1/4	.2505/.2550	THREE DOG SHAFT
5/16	.3160/.3220	THREE DOG DRIVE HUB
6mm	[6.01/6.13]	CURRENT TORQUES AVAILABLE
8mm	[8.02/8.18]	SLIP TORQUE: [0.2 N-m] 1.77 Lb-in ±20%
		SLIP TORQUE: [0.4 N-m] 3.54 Lb-in ±20%
		SLIP TORQUE: [0.8 N-m] 7.08 Lb-in ±20%
		SLIP TORQUE: [0.95 N-m] 8.41 Lb-in ±20%

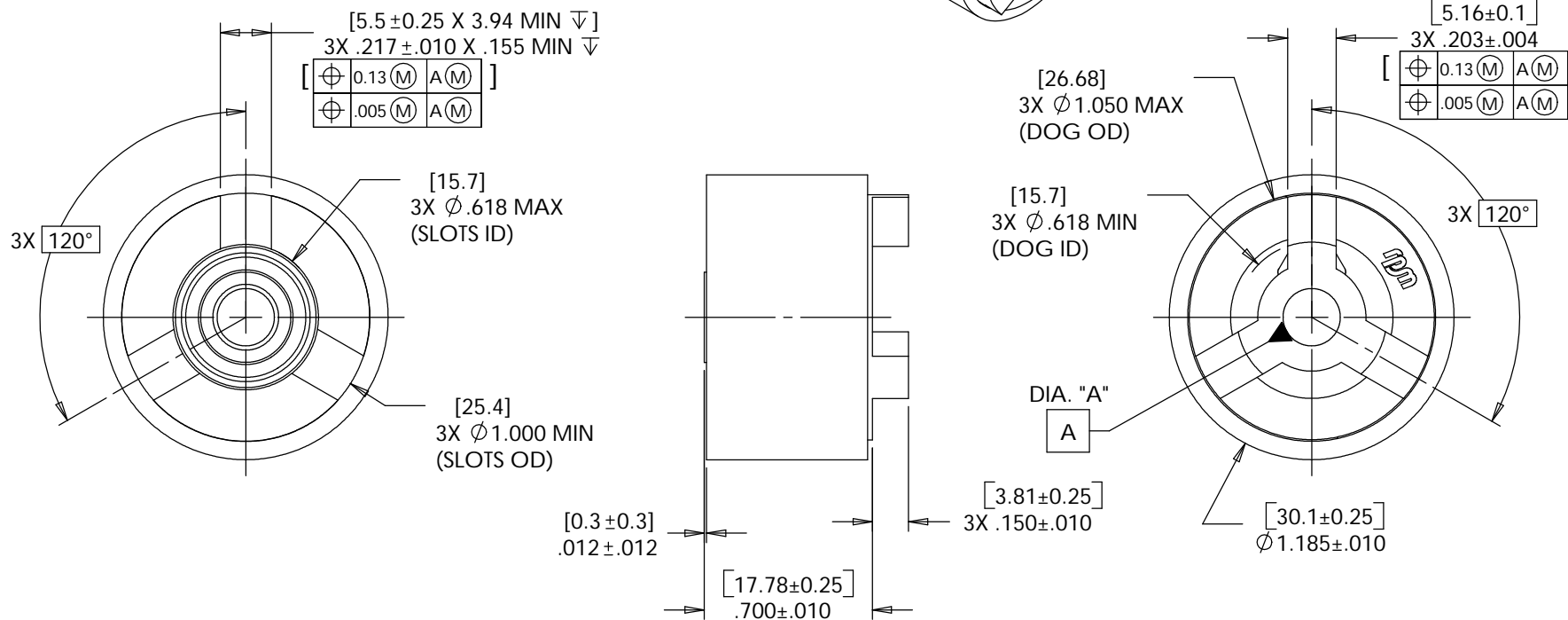
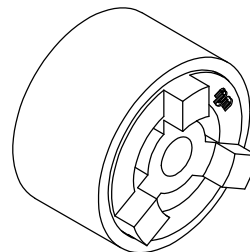

LEVEL	DESCRIPTION	DRAWN	DATE	APPROVED
DRAWN: DMT	DATE: 7-19-88	PART NO: 84-XXX		
CHECKED: GDL	DATE: 10-5-88	TITLE: HIGH INERTIA SLIP DEVICE		
APPROVED: GDL	DATE: 10-5-88	DESCRIPTION: SA		
REVISED: 4-5-01	DIMS: [mm]IN	REV: H		
SCALE: 1.5:1		DO NOT SCALE DRAWING		SHEET 1 OF 1

CONSISTENT WITH ASME Y14.5M-1994
THIS PRINT IS THE CONFIDENTIAL PROPERTY OF REELL PRECISION MFG.
THIRD ANGLE PROJECTION

REELL
REELL PRECISION MANUFACTURING
1259 WILLOW LAKE BOULEVARD
SAINT PAUL, MINNESOTA 55110-5103, USA