

NOTES:

1. LIFE IS 25,000 CYCLES OF 180° OPEN
180° CLOSED

2. AVAILABLE TORQUES:

PART NO.	[Nm]	Lb-in
32-006	[0.6]	5.3
32-008	[0.8]	7.1
32-010	[1.0]	8.9
32-012	[1.2]	10.6
32-014	[1.4]	12.4
32-016	[1.6]	14.2
32-018	[1.8]	15.9
32-020	[2.0]	17.7
32-022	[2.2]	19.5

3. TORQUE TOLERANCE: STATIC: +35% -15%
DYNAMIC: ± 15%

4. USER MUST DETERMINE FITNESS FOR USE
IN APPLICATION

5. RECOMMENDED MATING BRACKET HOLE
CONFIGURATION

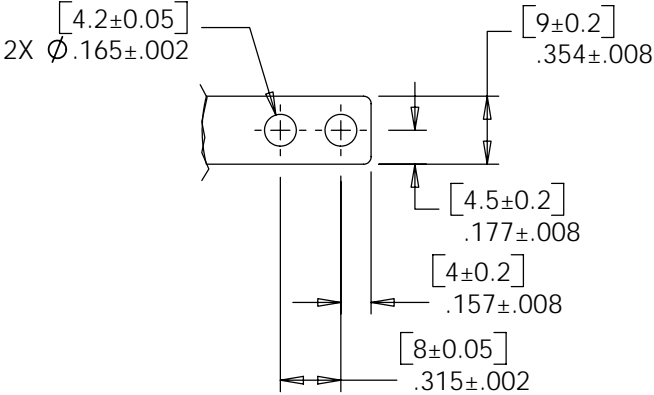
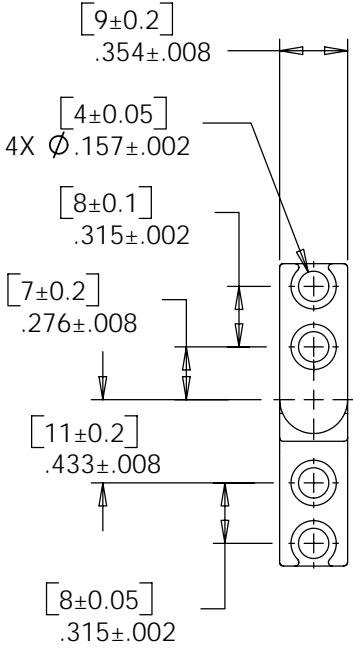
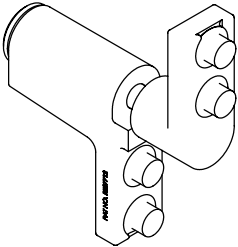

COMPRESS EACH RIVET AT [1,500 kgf]
3000 LBS WITH A FLAT PUNCH TO SECURE
BRACKETS TO HINGE [1] .039 TO [1.5] .059
THICK SHEET METAL

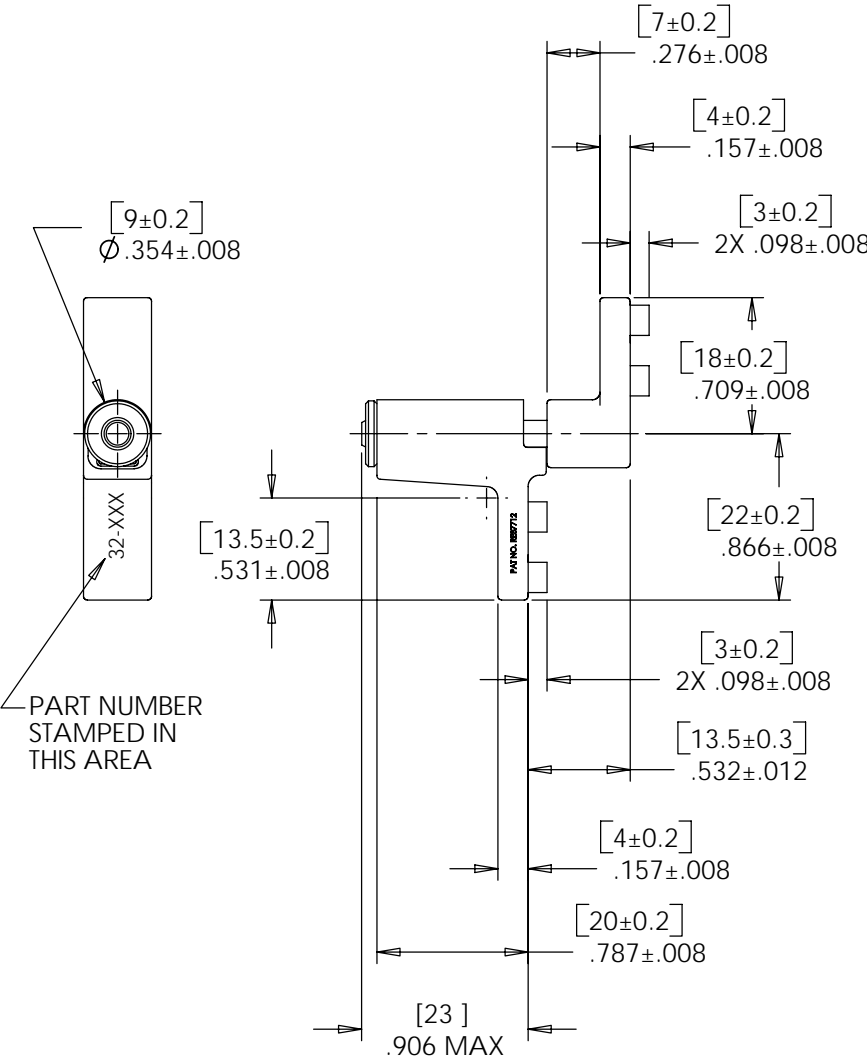

LEVEL	DESCRIPTION		DRAWN	DATE	APPROVED
DRAWN:	HMA	DATE: 1-18-99	PART NO: 32-XXX		
CHECKED:	JAK	DATE: 4-23-99	TITLE: POSITIONING HINGE ASSEMBLY		
APPROVED:	JAK	DATE: 4-23-99	DESCRIPTION: 9mm HINGE		
REVISED:	9-15-05	DIMS: [mm]IN	SCALE: 1:1		REV: H
CONSISTENT WITH ASME Y14.5M-1994 THIS PRINT IS THE CONFIDENTIAL PROPERTY OF REELL PRECISION MFG. THIRD ANGLE PROJECTION		REELL PRECISION MANUFACTURING 1259 WILLOW LAKE BOULEVARD SAINT PAUL, MINNESOTA 55110-5103, USA		DO NOT SCALE DRAWING SHEET 1 OF 1	

SPECIFICATIONS SUBJECT TO CHANGE