

PART NUMBER	STATIC TORQUE		
	NOMINAL	TOLERANCE	+/- %
12-000	0.4	[3.5]	35
12-001	0.8	[7.0]	25
12-002	1.2	[10.6]	20
12-003	1.6	[14.2]	20

- NOTES:
1. USER MUST DETERMINE FITNESS FOR USE IN APPLICATION.
  2. LIFE: 25,000 CYCLES.  
ONE CYCLE = 180° OPEN/180° CLOSED.  
FIVE(5) CYCLES PER MINUTE MAX.
  3. MATERIAL:  
BRACKET AND SHAFT END ARE ENGINEERED PLASTIC  
SHAFT AND TORQUE ELEMENT ARE HARDENED STEEL
  - 4] DESIGNED TO ACCEPT M4 OR #8 BUTTON HEAD SCREW OR EQUIVALENT.
  - 5] BRACKET TO BE ORIENTED ±5° WITH RESPECT TO DATUM A AS SHOWN.
  6. TOTAL TRAVEL 270°.
  7. DYNAMIC TORQUE IS NORMALLY WITHIN 10% OF STATIC TORQUE.

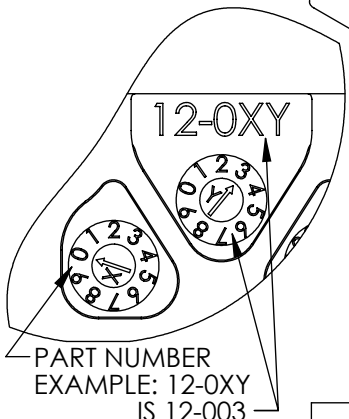
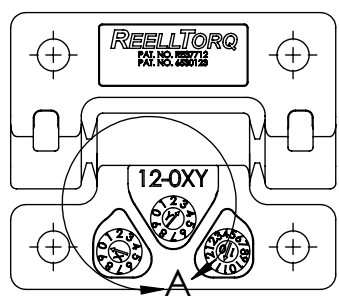
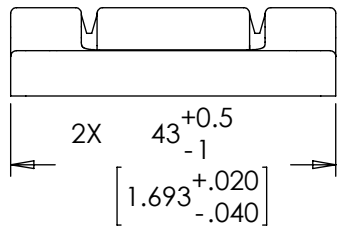

INTERPRET PRINT PER ASME Y14.5M-1994  
THIS PRINT IS THE CONFIDENTIAL PROPERTY OF REELL PRECISION MFG.  
THIRD ANGLE PROJECTION

LEVEL	DESCRIPTION	DRAWN	DATE	APPROVED
DRAWN: JDR	DATE: 26FEB09	REFERENCE: 12-XXX		
CHECKED: TWJ	DATE: 27MAR09	TITLE: MOLDED HINGE ASSEMBLY		
APPROVED: TWJ	DATE: 27MAR09	PART NO: MH12 SERIES		
REVISED: 11OCT10	DIMS: mm[IN]	REV: E		
REELL PRECISION MANUFACTURING 1259 WILLOW LAKE BOULEVARD SAINT PAUL, MINNESOTA 55110-5103, USA		SCALE: 1:1	DO NOT SCALE DRAWING	SHEET 1 OF 1

SPECIFICATION SUBJECT TO CHANGE