

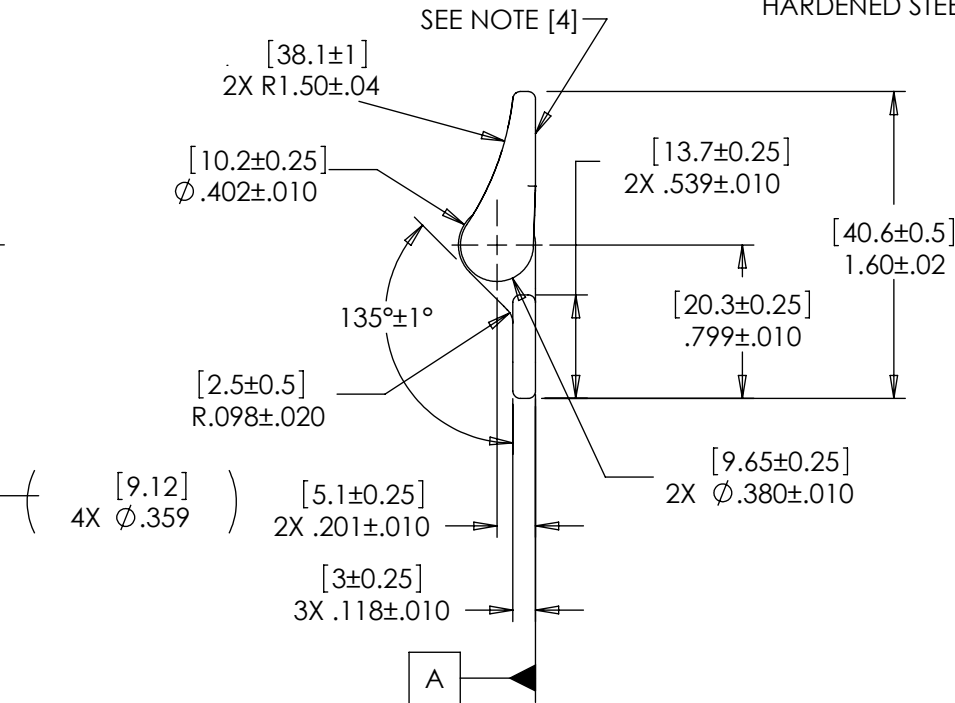

NOTES: 1.

TORQUE	PLAIN	BLACK
[INCHES] mm	PART NO.	PART NO.
[3.9] Lb-in 0.44 Nm	28-004	28-104
[6.9] Lb-in 0.78 Nm	28-008	28-108
[10.8] Lb-in 1.22 Nm	28-012	28-112
[13.9] Lb-in 1.57 Nm	28-016	28-116
[17.8] Lb-in 2.01 Nm	28-020	28-120
[20.8] Lb-in 2.35 Nm	28-024	28-124
[24.7] Lb-in 2.79 Nm	28-030	28-130

2. TORQUE TOLERANCE: $\pm 20\%$
3. LIFE: 20,000 CYCLES WHEN DUTY CYCLE IS LESS THAN 10% AND ROTATIONAL SPEED IS LESS THAN 100 RPM. 30 SECONDS MAXIMUM CONTINUOUS ACTUATION.
- [4] FLATS TO BE ORIENTED $\pm 5^\circ$ WITH RESPECT TO DATUM A AS SHOWN.
- [5] DESIGNED TO ACCEPT M4 OR #8 SCREW OR EQUIVALENT
6. USER MUST DETERMINE FITNESS FOR USE IN APPLICATION
7. MATERIAL:
BRACKET AND SHAFT END ARE ZINC
SHAFT AND TORQUE ELEMENT ARE HARDENED STEEL

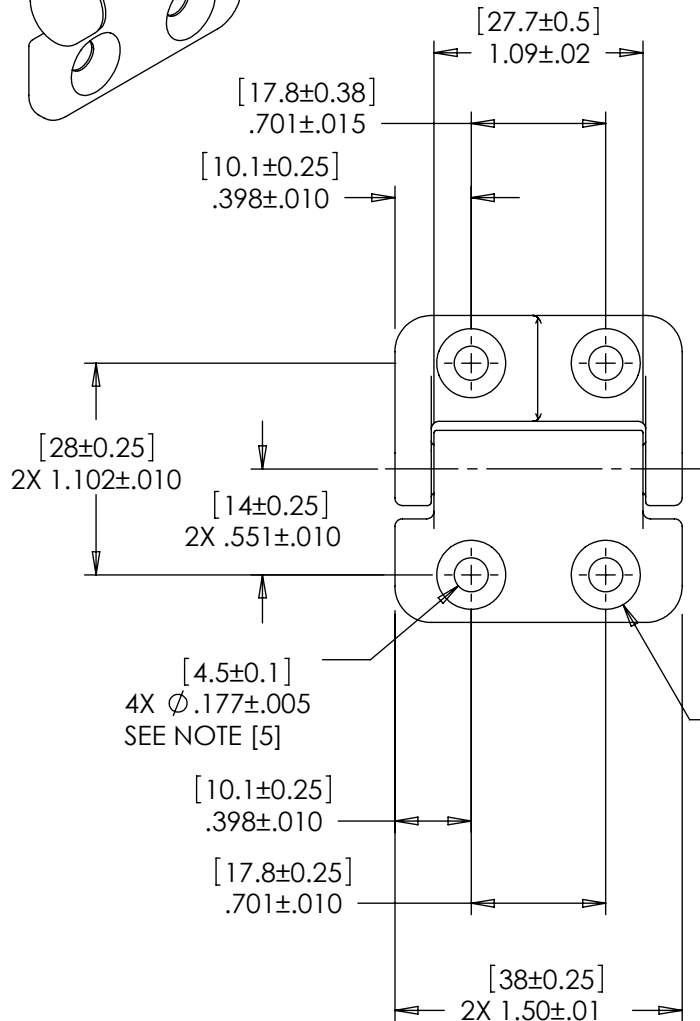

LEVEL	DESCRIPTION	DRAWN	DATE	APPROVED
DRAWN: HMA	DATE: 3-1-02	PART NO: 28-XXX		
CHECKED: HMA	DATE: 3-1-02	TITLE: POSITIONING HINGE		
APPROVED: TWJ	DATE: 3-14-02			
REVISED: 6-22-11	DIMS: [mm]IN	DESCRIPTION: PHC SERIES WITH COUNTERSINKS		REV: F
INTERPRET PRINT PER ASME Y14.5M-1994 THIS PRINT IS THE CONFIDENTIAL PROPERTY OF REELL PRECISION MFG. THIRD ANGLE PROJECTION				SCALE: 1:1
REELL PRECISION MANUFACTURING 1259 WILLOW LAKE BOULEVARD SAINT PAUL, MINNESOTA 55110-5103, USA		DO NOT SCALE DRAWING		SHEET 1 OF 1

SPECIFICATIONS SUBJECT TO CHANGE